

Other Variations

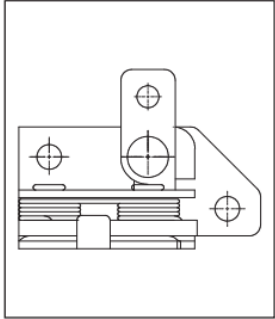

No. 6-300-R&L

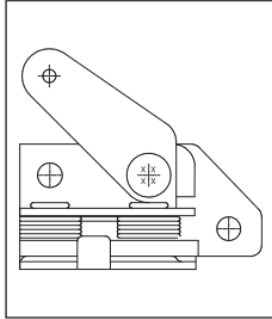

No. 7-300-R&L

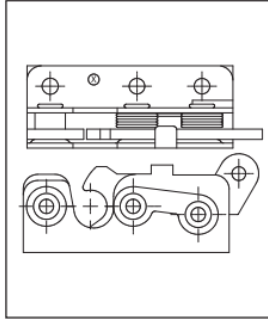

No. 8-300-R&L

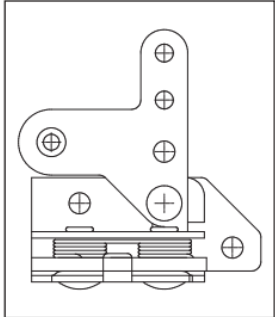

No. 9-300-R&L

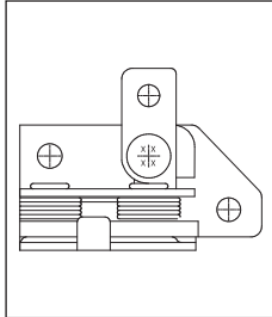

No. 18-300-R&L

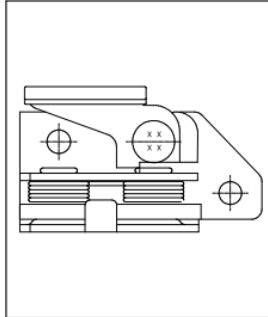

**No. 19-300-R&L
Plastisol Handle**

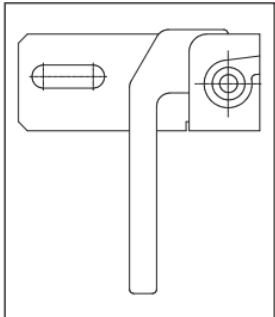

No. 20-300-R&L

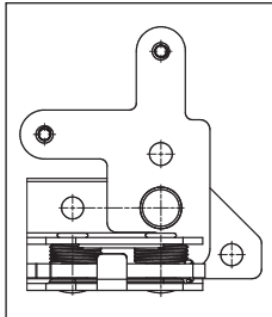

No. 39-300-R&L

No. 16-300-R

Uniquely designed rotary latch satisfies a wide variety of application requirements. Ideal to fit tubular constructed bulk handling containers. Trip lever designed for ease of activation when needed.

Finish: Zinc-plated

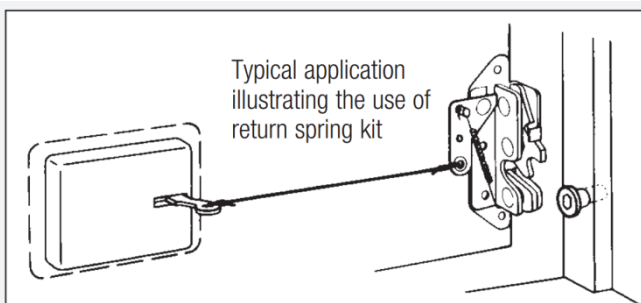

No. 2-300-P5

Lever Arm Return Spring Kit. Has heavy (29.3 lb./in.) spring.

No. 3-300-P5

Lever Arm Return Spring Kit. Has light (2.7 lb./in.) spring.



We are Eberhard's exclusive distributor